

3D View

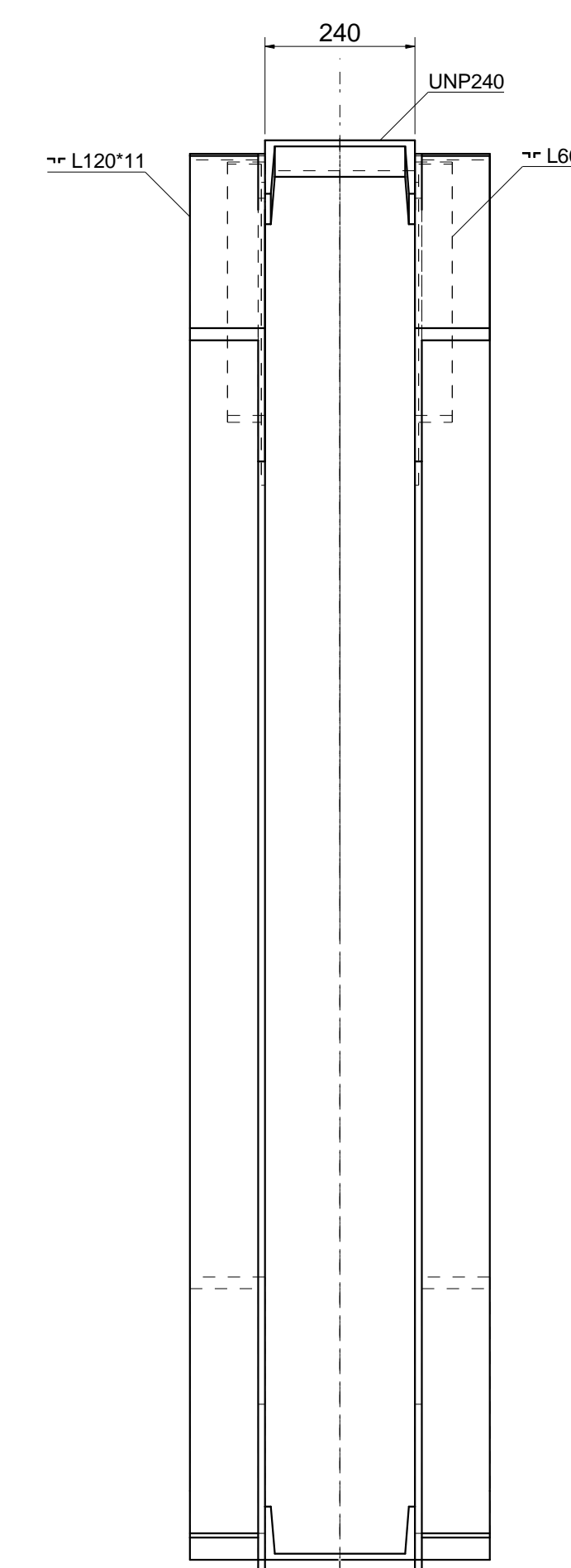

B - B

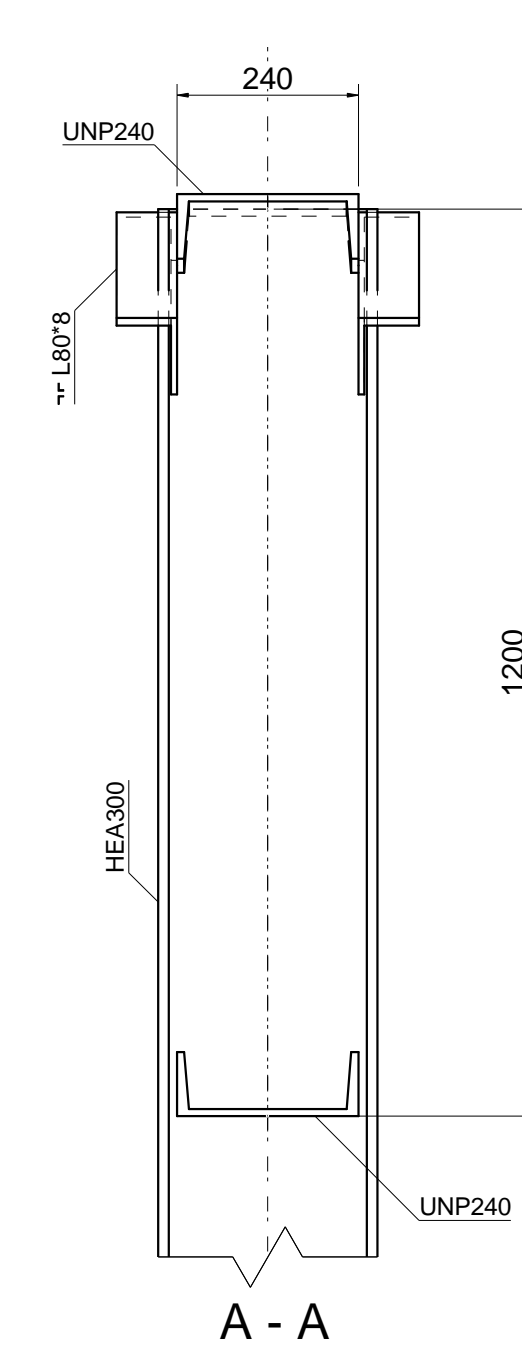
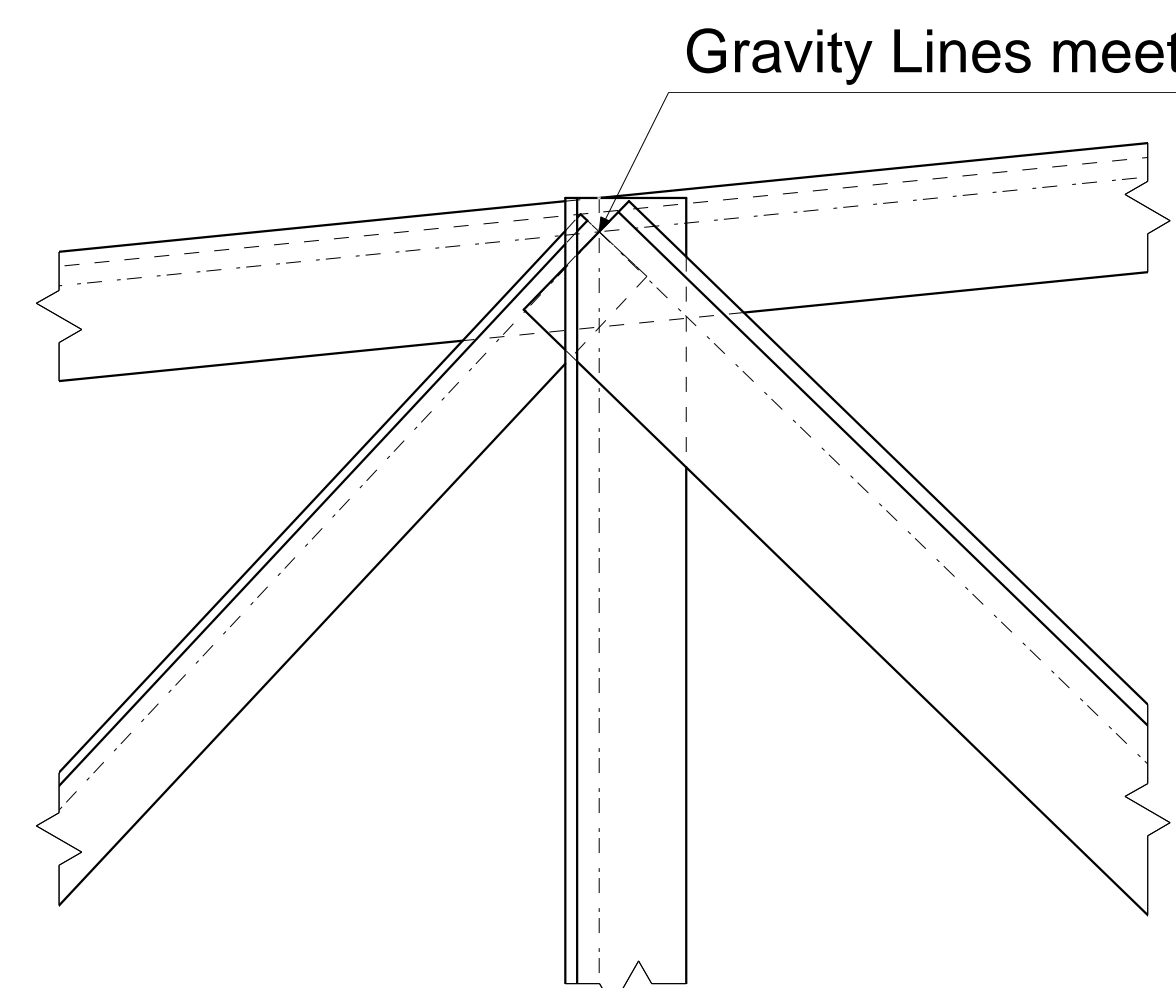

(Gravity Line) Detail 1

Model the Truss as shown keeping the following in mind.

1. The top chord and bottom chords are UNP240
2. Verticals and Diagonal and Secondary profiles of the truss vary as shown.
3. All back to back angles have a distance of 240 between them so that their inner distance is the same as the height of the top and bottom chords. (See Sectional views)
4. Ensure that the gravity lines of all truss members coincide and there are NO eccentricities AS SHOWN in the drawing (IMPORTANT). Use "Auto Adjust" feature to achieve this result
5. Using "AUTO ADJUST" on the truss diagonals will NOT disturb the definition lines and use end offsets to get the desired result.
6. Use "Twin Profiles" to model the Truss diagonals, verticals and secondaries.
7. You can watch a video on this topic here. <https://youtu.be/B9CA0APjNj4>
8. The Truss is symmetric around the center so you can model only one side if you want.